

PM Conformity Hot Spot Analysis – Project Summary for Interagency Consultation

RTIP ID# LALS06					
TCWG Consideration Date February 22, 2022					
<p>Project Description <i>(clearly describe project)</i> The project proposes to widen the southbound Interstate 405 (I-405) on-ramp at Ventura Boulevard (Blvd). The on-ramp will be modified from a Single Occupant Vehicle (SOV) lane plus one High Occupancy Vehicle (HOV) lane to a three metered SOV lanes. A new curb ramp at the beginning of the ramp entrance needs to be constructed as a result of widening the on-ramp. Provision is made for the relocation of light poles, control boxes, and irrigation systems. A paved Maintenance Vehicle Pullout (MVP) is also recommended to be constructed upstream of the metering controller cabinet.</p> <p><i>(see attached project plans and layouts)</i></p>					
<p>Type of Project <i>(use Table 1 on instruction sheet)</i> Intersection Channelization</p>					
County LA		<p>Narrative Location/Route & Postmiles The proposed project is located on Interstate 405 (I-405) southbound on-ramp at Ventura Blvd in the community of Sherman Oaks in the City of Los Angeles, Los Angeles County (Post Mile 39.09).</p> <p>Caltrans Projects – EA# 20490</p>			
Lead Agency: Caltrans					
Contact Person Andrew Yoon		Phone# 213-266-6892	Fax# 213-897-0683	Email Andrew_yoon@dot.ca.gov	
Hot Spot Pollutant of Concern <i>(check one or both)</i> PM2.5 x PM10 x					
Federal Action for which Project-Level PM Conformity is Needed <i>(check appropriate box)</i>					
x	Categorical Exclusion (NEPA)	EA or Draft EIS	FONSI or Final EIS	PS&E or Construction	Other
Scheduled Date of Federal Action: March 2020					
NEPA Assignment – Project Type <i>(check appropriate box)</i>					
Exempt		x	Section 326 – Categorical Exemption	Section 327 – Non-Categorical Exemption	
Current Programming Dates <i>(as appropriate)</i>					
	PE/Environmental	ENG	ROW	CON	
Start	12/3/2018	3/26/2020	4/16/2020	5/26/2022	
End	4/1/2020	12/20/2021	2/28/2022	7/1/2024	

Project Purpose and Need (Summary): *(attach additional sheets as necessary)*

The purpose of the proposed project is to enhance operating conditions at southbound Interstate (I-405) on-ramp at Ventura Boulevard (Blvd). The southbound I-405 at the project location consists of 5 Mixed Flow Lanes (MFL) and a High Occupancy Vehicle (HOV) lane. The on-ramp consists of two single SOV lanes that merges to one lane near the ramp gore area. Traffic entering the southbound Ventura Boulevard on-ramp from westbound Ventura Boulevard is creating queuing upstream of the ramp meter and onto the city surface street. The extensive queuing blocks access to a nearby bus stop pocket and causes buses to overflow and block the adjacent through traffic movements, which subsequently results in additional congestion and weaving issues from the opposing traffic that utilizes the same on-ramp access. Queues have been observed extending up the on-ramp and onto Ventura Blvd and reaching as far downstream as Sepulveda Blvd and block that intersection. The two-lane terminus is approximately 40 meters long and provides little storage capacity along the on-ramp. Due to the critical location of this segment along I-405 and the importance of providing acceptable operations for commuters, the proposed improvements at this on-ramp are anticipated to enhance the existing conditions at the Ventura Boulevard intersection.

Surrounding Land Use/Traffic Generators *(especially effect on diesel traffic)*

Land uses along Ventura Blvd near the project limits predominantly include single and multi-family residentials as well as commercial uses. The Sherman Oaks Galleria is located nearby at Sepulveda Blvd/Ventura Blvd intersection.

Opening Year: If facility is an interchange(s) or intersection(s), Build and No Build cross-street AADT, % and # trucks, truck AADT

ADT = 6,300; Truck % = 2%

	Direction	Peak Hour Volumes		LOS		Delay		
		AM	PM	AM	PM	AM	PM	
Opening Year (2025)	Northbound Sherman Oaks Ave	LT	202	173	E	D	71	47
		T	22	17				
		RT	202	173				
	I-405 Ventura Off-Ramp	LT	323	254				
		T	50	51				
		RT	323	250				
	Eastbound Ventura Blvd	LT	278	163				
		T	1171	1604				
		RT	362	203				
	Westbound Ventura Blvd	LT	172	235				
		T	895	1922				
		RT	647	190				

Note: Build and No-Build data are the same

RTP Horizon Year / Design Year: If facility is an interchange (s) or intersection(s), Build and No Build cross-street AADT, % and # trucks, truck AADT

ADT = 6,600; Truck % = 2%

	Direction	Peak Hour Volumes		LOS		Delay		
		AM	PM	AM	PM	AM	PM	
Design Year 2045	Northbound Sherman Oaks Ave	LT	206	179	E	E	76	62
		T	23	18				
		RT	206	179				
	I-405 Ventura Off-Ramp	LT	330	263				
		T	52	53				
		RT	330	263				
	Eastbound Ventura Blvd	LT	284	169				
		T	1196	1658				
		RT	370	210				
	Westbound Ventura Blvd	LT	175	243				
		T	913	1988				
		RT	661	196				

Note: Build and No-Build are the same

Describe potential traffic redistribution effects of congestion relief (impact on other facilities)

The goal of the project is to improve the operational condition of the southbound Ventura Blvd on-ramp. This will be accomplished by increasing on-ramp vehicle storage capacity through widening the ramp to create three SOV lanes. Project improvements are not expected to result in redistribution of traffic to or from adjacent interchanges nor have a considerable effect on other facilities.

Comments/Explanation/Details *(attach additional sheets as necessary)*

The project proposes to widen the southbound I-405 on-ramp at Ventura Blvd. Proposed project is anticipated to enhance operating conditions at the southbound Ventura Blvd on-ramp. Based on the traffic data identified above, the proposed project is not anticipated to result in new or worsened PM2.5 or PM10 violations. Therefore, the project is considered not to be of air quality concern for PM2.5 and PM10.

STATE OF CALIFORNIA - DEPARTMENT OF TRANSPORTATION
Stantec
DESIGN C

FUNCTIONAL SUPERVISOR
 REFUGIO DOMINGUEZ

CALCULATED BY
 DESIGNED BY
 CHECKED BY

MADELINE WCHA
 REFUGIO DOMINGUEZ

REVISED BY
 DATE REVISED

NOTES:

1. FOR ACCURATE RIGHT OF WAY DATA, CONTACT RIGHT OF WAY ENGINEERING AT THE DISTRICT OFFICE.

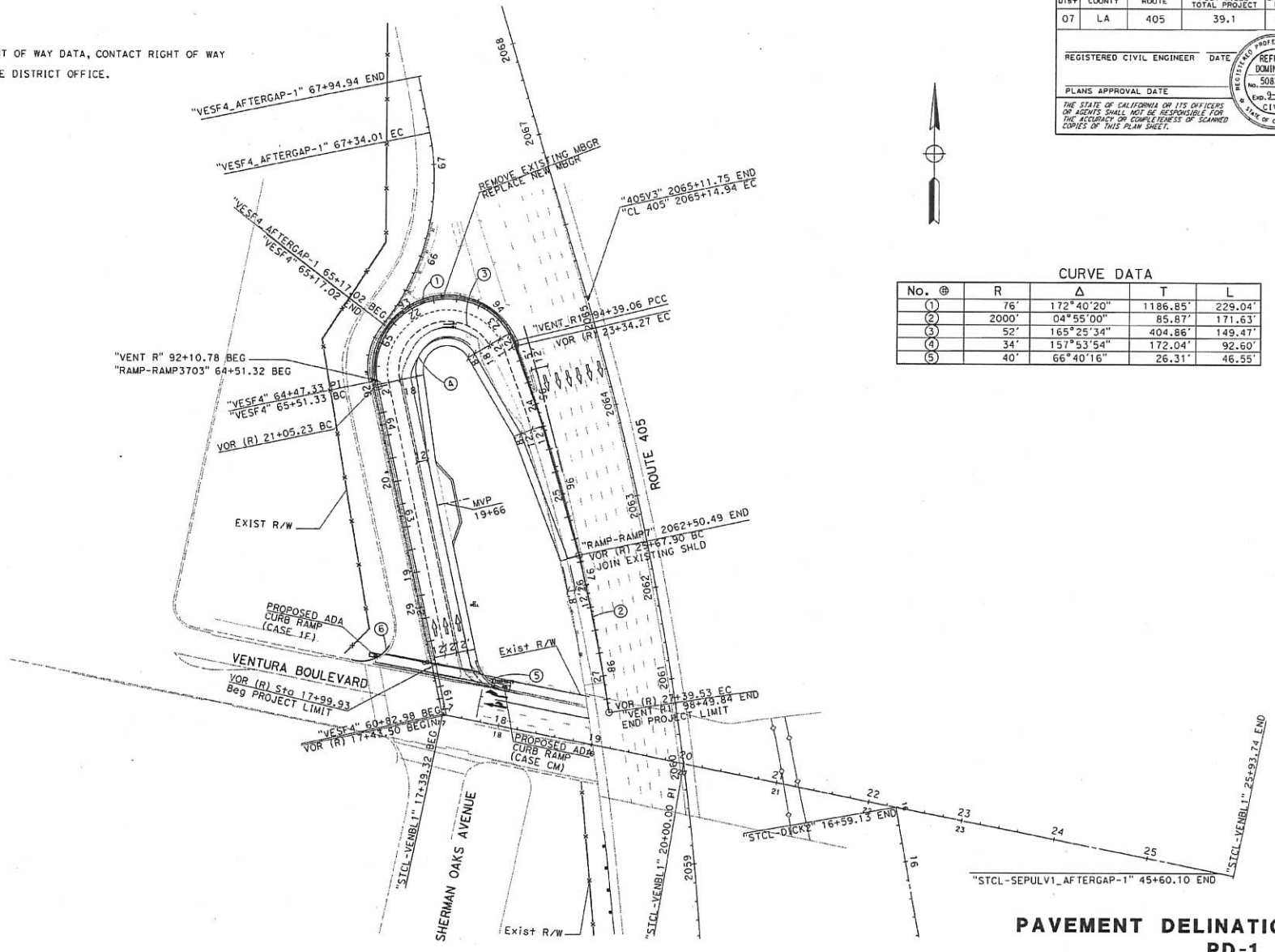

CURVE DATA

No. @	R	Δ	T	L
①	76'	172°40'20"	1186.85'	229.04'
②	2000'	04°55'00"	85.87'	171.63'
③	52'	165°25'34"	404.86'	149.47'
④	34'	157°53'54"	172.04'	92.60'
⑤	40'	66°40'16"	26.31'	46.55'

Dist	COUNTY	ROUTE	POST MILES TOTAL PROJECT	SHEET TOTAL SHEETS
07	LA	405	39.1	x

REGISTERED CIVIL ENGINEER DATE _____

PLANS APPROVAL DATE _____

THE STATE OF CALIFORNIA OR ITS OFFICERS OR AGENTS SHALL NOT BE RESPONSIBLE FOR THE ACCURACY OR COMPLETENESS OF SCANNED COPIES OF THIS PLAN SHEET.

REGISTERED PROFESSIONAL ENGINEER
 REFUGIO DOMINGUEZ
 No. 50829
 Exp. 2-30-21
 CIVIL
 STATE OF CALIFORNIA

BORDER LAST REVISED 7/2/2010

USERNAME => r133273
 DCN FILE => 0720490na001.cgn

RELATIVE BORDER SCALE 0 1 2 3
 15 IN INCHES

UNIT 1819

PROJECT NUMBER & PHASE 071700022

LOI: 000001 DATE PLOTTED => 20-MAR-2020
 00-00-00 TIME PLOTTED => 09:18